

# VERSATILE Wheel Wash

## MINI ASSEMBLY

The following parts are supplied with the Mini Wheel Wash System:

- 1 x Galvanised steel box**
  - approx 1m x 1.5m x 1m high containing 1 x 4Kw end suction pump control panel, isolators & pipe work etc.
- 1 x Heavy duty box section grid**
  - 6ft long x 11ft wide & fully galvanised
- Spray bars (all galvanised components)**
  - 2 x floor mounted, 2 x side mounted & 24 x high volume, wide angle spray nozzles
  - 2 x side shields to reduce overspray
- 1 x 550 gallon (2500L) GRP water storage tank**

## STANDARD/EXTENDED ASSEMBLY

The following parts are supplied with the Standard and Extended Wheel Wash Systems:

- 1 x DPS wheel wash pump control cabinet**
  - 8ft x 10ft double doors, 4 adjustable jack legs & security locks
  - 1 x 550 gallon (2500L) GRP header tank, ballcock & drain valve
  - 1 x 18.5Kw main wash pump with solenoid valve 24V
  - 1 x 2.2Kw recycling pump
  - 1 x recycling self-clean filter assembly with automatic controls
  - 1 x 1.5Kw manual wash down pump with 5m hose & reel
  - 1 x motor control centre with 24V supply for all float switches & control circuits
  - 1 x anti-frost heater and internal lights
  - All necessary pipework, wiring, controls, float switches, sensors & ready for site connections
- Heavy duty galvanised steel wash grid**
  - STANDARD: 2 sections & 3600mm long
  - EXTENDED: 3 sections & 5400mm long
  - Side protection shields: 1830mm high, full length & galvanised
- Spray bars**
  - 6 or 8 galvanised steel spray bars (2 side mounted and 4 or 6 floor mounted) with high volume wide angle spray nozzles
  - Flow: 1000L/Min at 7 bar
- Automatic electronic control**
  - 2 x support stands for eye beam assemblies
  - Low voltage start up signal with adjustable run timer

### All necessary plumbing fittings

### To be supplied by the user

- Power supply 415/3/50 TPNE 100A
- Cranage at site
- Water supply to container
- Civil works to include: Wheel wash base, settlement tanks & recycling tanks



## The Local Base for Fluid Engineering

- Borehole pumping equipment
- Control systems
- DAB circulating pumps, pressure sets & submersibles
- Decorative fountain systems
- Ebara stainless steel submersible & surface mounted pumps
- Engine pumps and generators
- Filtration systems
- Fristam positive displacement & centrifugal hygienic pumps
- Irrigation equipment and systems
- KSB submersible and industrial pumps
- Mechanical and electrical fittings
- Mixing and aeration solutions
- Mole ploughing
- Packaged Sewage stations
- Ranges of AOD, dosing & peristaltic pumps
- Rock drilling equipment
- Seepex progressive cavity pumps & macerators
- Sewage treatment plants
- Sports ground Irrigation systems
- Versatile wheel wash
- Versatile dirty water irrigation
- Versatile dust suppression systems
- Willand ultra violet disinfection

Our range of products, skills and services includes design, specification, sales, installation, after sales and on-site/workshop servicing & maintenance.

### Contact Details

Drilling and Pumping Supplies Ltd.  
29 Jubilee Road  
Comber Road Industrial Estate  
Newtownards  
Co. Down BT23 4YJ

Tel: 028 9181 8347  
(ROI: 048 9181 8347)  
Fax: 028 9181 3837  
(ROI: 048 9181 3837)  
Email: sales@dps-ni.com

[www.dps-ni.com](http://www.dps-ni.com)



VERSATILE

# Wheel Wash



## The Environmental Wheel Wash System

[www.dps-ni.com](http://www.dps-ni.com)





# VERSATILE Wheel Wash

This market leading wheel wash system is the solution to all your cleaning needs.

Stringent new Government legislation states that if your business is involved in construction, land development, landfill, quarrying, mining, waste disposal, manufacturing or distribution then you are responsible for preventing the carriage of site dirt and waste from site traffic onto public roads.

The Versatile range of Wheel Wash Systems have been specially developed and modified over many years to produce an effective and trouble free solution to the problem of road surface contamination from site dirt and waste. Each market leading package has been designed from long lasting materials to be simple, cost-effective and safe.

With many installations throughout Ireland, Drilling and Pumping Supplies are continuously upgrading the Versatile Wheel Wash System to meet the requirements of the ever changing market. We pride ourselves on our ability to produce a system which can adapt to every situation whilst remaining effective.

Currently Versatile Wheel Wash Systems are available in three varying lengths; the Mini, the Standard and the Extended system, each of which is available in a fixed or transportable option.

FEATURES	BENEFITS
Galvanised steel construction	Long lasting
Water recycling options	Environmentally friendly
Approx 100-250 gallons per wash	Reduced running costs
Electronic beam	No need for manual operation

[www.dps-ni.com](http://www.dps-ni.com)

## Fixed Vs Transportable

The fixed range of Versatile Wheel Wash Systems are normally found in situations where a permanent installation is required, such as quarries and large landfill sites etc. Contained within these installations are underground settlement lagoons, each fitted with self clean filters which act as a water recycling method, thus making it very environmentally friendly. Site excavation and civil works are required for the installation of a fixed Versatile Wheel Wash System, for which drawings are available.

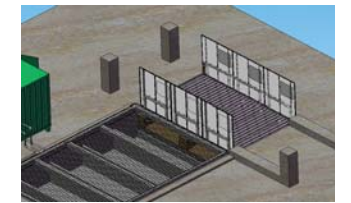

Fixed System

Conversely the transportable range of Versatile Wheel Wash Systems are used when the location is of a more temporary nature, such as construction sites or small land fill sites. These would normally use either no recycling system or an above ground siltbuster recycling system, and will normally only require minor civil works consisting of a concrete base and collection sump.

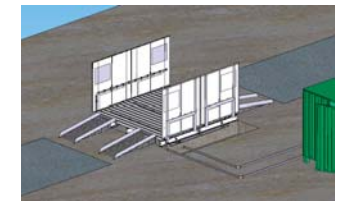

Transportable System

## The Versatile Wheel Wash Range

### VERSATILE MINI WHEEL WASH [MF OR MT]

FEATURES	APPLICATIONS
<ul style="list-style-type: none"> <li>Light duty system (24 spray nozzles)</li> <li>Less power required (5.5Kw)</li> <li>Less water usage</li> <li>Compact design</li> <li>Economic</li> </ul>	<ul style="list-style-type: none"> <li>Water transfer stations</li> <li>Sewage sites</li> <li>Small landfill sites</li> <li>Animal processors</li> <li>Construction sites</li> </ul>



Mini Fixed [MF]



Mini Transportable [MT]

### VERSATILE STANDARD WHEEL WASH [SF OR ST]

FEATURES	APPLICATIONS
<ul style="list-style-type: none"> <li>Medium duty system</li> <li>18.5Kw power usage</li> <li>48 spray nozzles</li> <li>Containerised wash control centre</li> </ul>	<ul style="list-style-type: none"> <li>Sand pits</li> <li>Quarries</li> <li>Landfill sites</li> <li>Large Construction sites</li> </ul>



Standard Fixed [SF]



Standard Transportable [ST]

### VERSATILE EXTENDED WHEEL WASH [EF OR ET]

FEATURES	APPLICATIONS
<ul style="list-style-type: none"> <li>Large duty system</li> <li>18.5Kw power usage</li> <li>Powerful spray pattern</li> <li>72 spray nozzles</li> <li>Containerised wash control centre</li> </ul>	<ul style="list-style-type: none"> <li>Quarries</li> <li>Landfill sites</li> <li>Large construction sites</li> </ul>



Extended Fixed [EF]



Extended Transportable [ET]